

# Signal lamps for doors & gates

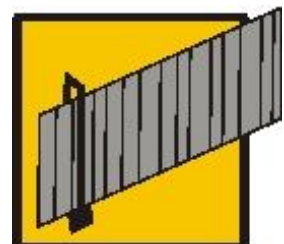
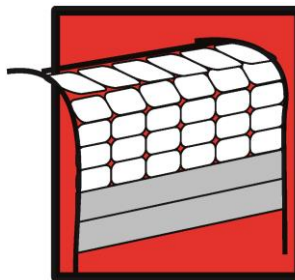
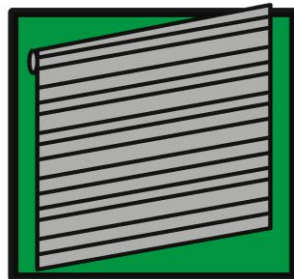

## Quadra-Lux

Practice-oriented version for the door and gate industry

# Signal lamp: Quadra-Lux – with LED technology

Our new signal lamp Quadra-Lux distinguishes from other models by an innovative design, easy handling and its modularity.

The signal lamp is equipped with the latest LED technology consisting of 12 high-power diodes and several safety circuits.

The mounting can be made directly onto the wall. Alternatively you can mount it with a mounting bracket and the option to swivel it 90 degrees.

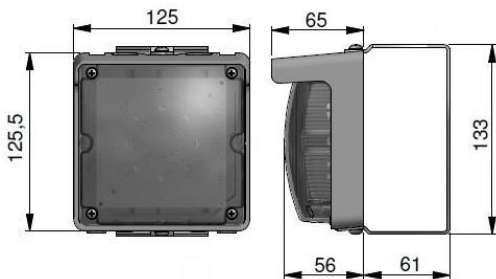

## The main features are :

- Ultra-flat, aesthetic design
- Operating voltage of 24V or 230V
- Protection class IP 65
- Max. light yield with min. energy consumption
- Easy assembly with dovetail guide
- 12 ultra-bright LEDs
- Permanent light or flashing possible

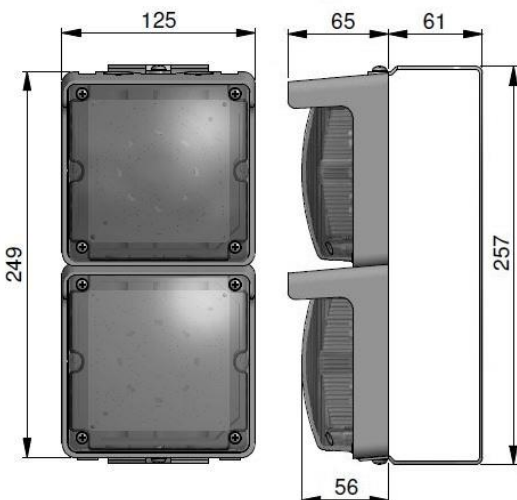
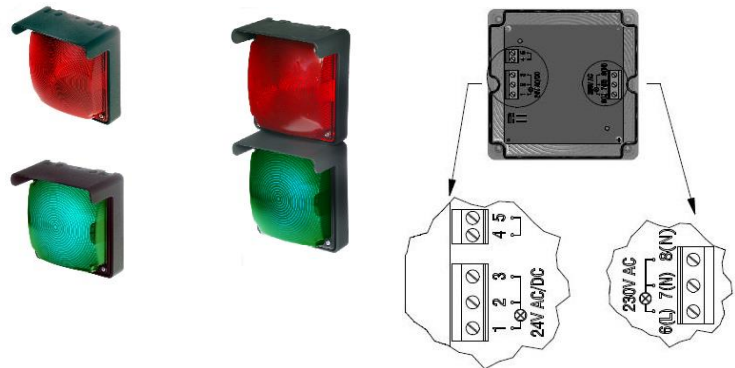
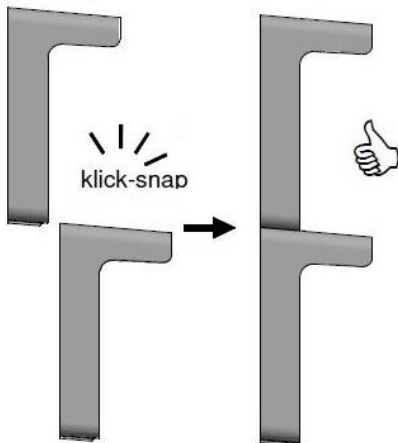

Types:	Article no.:
Signal lamp red	905.SLRL.00
Signal lamp green	905.SLGL.00
Signal lamp set red	905.SLSL.10
Signal lamp set green	905.SLSL.30
Signal lamp set red & green	905.SLSL.20

Technical data:	
Operating voltage:	24V AC/DC or 230V AC
Protection class:	IP 65
Temperature range:	-30°C to +50°C
Lens diameter:	approx. 175 mm
Lens material:	Polycarbonate
Material of the enclosure:	Glass Reinforced Polypropylene